

# Campus Corners

4243 Dunn Avenue, Jacksonville, FL 32218

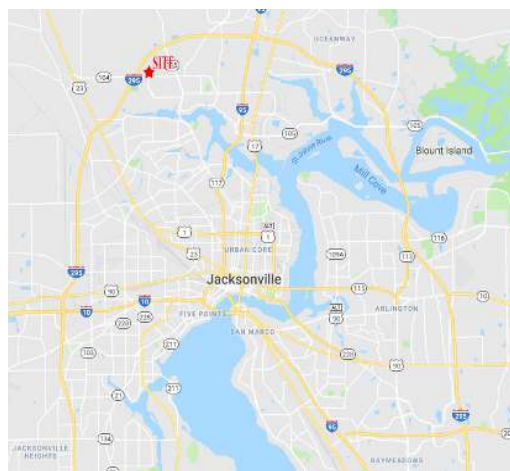

LOCATION ZONE: NASSAU COUNTY



New development

Close proximity to I-295 with 72,500 VPD

## CO-TENANTS

- Goodwill
- 7-Eleven



## LEASING CONTACT

**CeeDee Morris**

470-723-6068

cmorris@sleiman.com

**SLEIMAN**

1 Sleiman Parkway  
Jacksonville, FL 32216

904-731-8806

[SLEIMAN.COM](http://SLEIMAN.COM)

DEMOGRAPHICS	1 MILE	3 MILES	5 MILES
Population	6,921	41,674	82,978
2025 Population Projected	7,081 0.5%	43,326 0.8%	87,339 1.1%
Income	\$57,769	\$58,224	\$57,498
Households	2,490	15,674	31,897
Median Age	35.2	37.5	39.1

# Campus Corners

4100 Dunn Avenue, Jacksonville, FL 32218

LOCATION ZONE: Northside/Nassau County

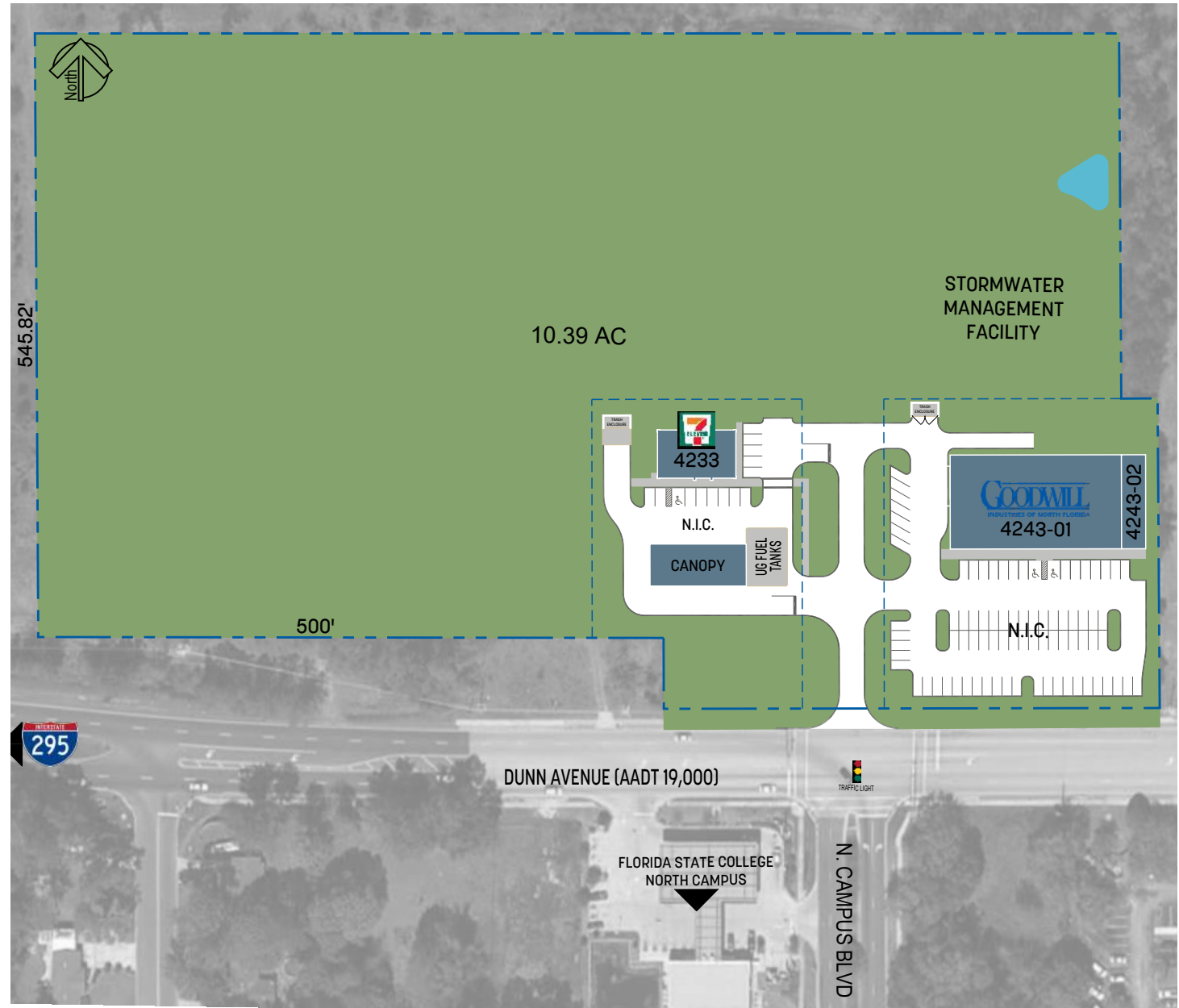

SITE SUMMARY			
	TENANT	ADDRESS	SIZE
	GOODWILL	4243-01	12,727 sf
	JOB JUNCTION	4243-02	1,787 sf
	7-ELEVEN (BLDG 3,140 sf)	4233	1.12 ac

This site plan is presented solely for the purpose of identifying the approximate location and size of the building presently contemplated by the owner. Building sizes, site dimensions, access and parking areas, existing tenant locations and identities are subject to changes without notice and at the owners discretion. Unit numbers as indicated are not necessarily the actual suite number and are intended for use as reference only.